

PART NUMBER
10120045-200LF

*** Please contact Barbara.Maier@codico.com to get more information! ***

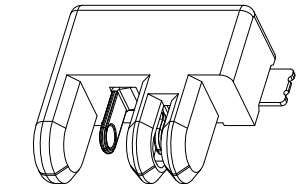

SCALE 3.000

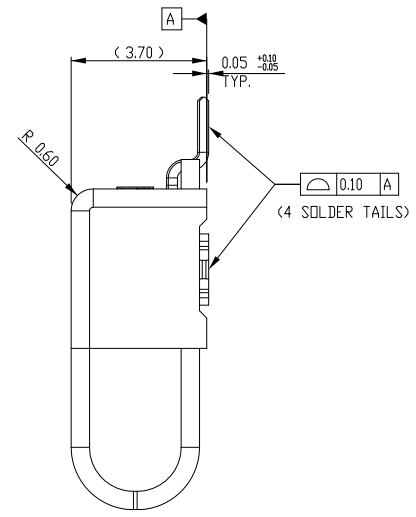
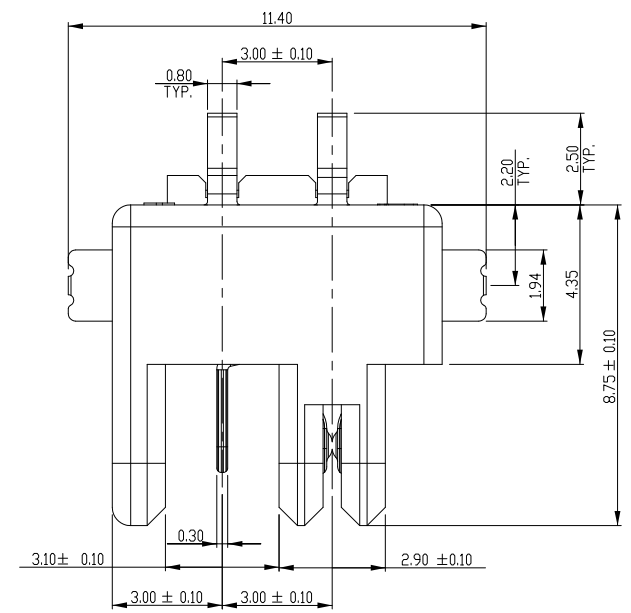
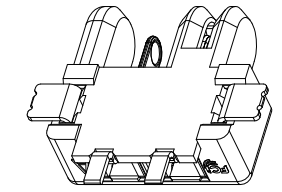

SCALE 3.000

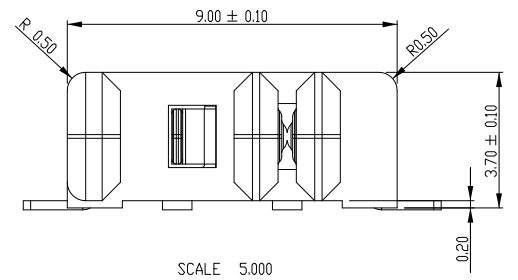

SCALE 5.000

NOTES:
 1. MATERIAL:
 HOUSING: HIGH TEMPERATURE LCP,NATURAL
 UL 94 V-0 FLAME RETARDANT.
 CONTACTS: COPPER ALLOY.
 PLATING SPEC AS BELOW:
 FOR CONTACT AREA:
 * 0.76um GX™ (30°GXT™);
 FOR SOLDER AREA:
 MATTE PURE TIN 3 um MIN.
 FOR UNDERPLATING:
 1.27 um MIN.THICKNESS NICKEL
 2. PRODUCT SPEC. GS-12-1079.
 3. LEAD FREE NOTES:
 3a.THE HOUSING WILL WITHSTAND EXPOSURE TO 260°C PEAK
 TEMPERATURE FOR 10 SECONDS IN A CONVECTION, INFRA-RED
 OR VAPOR PHASE REFLOW OVEN.
 3b.THIS PRODUCT MEETS EUROPEAN UNION DIRECTIVES AND
 OTHER COUNTRY REGULATIONS AS DESCRIBED IN GS-22-008.
 * GX™ is an FCI Electronics patented process of palladium-nickel alloy plated with a gold flash.



Copyright FCI.

rev	ecn no	dr	date
A	-	MJA	2013-06-10
-	-	-	-
-	-	-	-
-	-	-	-
-	-	-	-
-	-	-	-

www.fciconnect.com			surface ISO 1302 ✓	tolerance std ISO 406 ISO 1101	projection ⊕ ⊖	MM ↔
Dr	M JACOB	2013-06-10	ANGULAR	0.x ±x	size A4	Scale 5.000
Eng	M JACOB	2013-06-10	LINEAR	0.xx ±0.2	ECN	-
Chr	M JACOB	2013-06-10	0° ±2°	0.xxx ±x	Spec ref	-
Appr	BIJU K PAUL	2013-06-10	Product family-RotaConnect			
FCI			title ASSEMBLY, 2 POS HDR TYPE ROTATABLE BOARD TO BOARD CONNECTOR		part no 10120045-200C	Rev. A
			catalog no : 10120045-200LF		CUSTOMER DRAWING sheet 1 of 3	

PART NUMBER
10120045-200LF

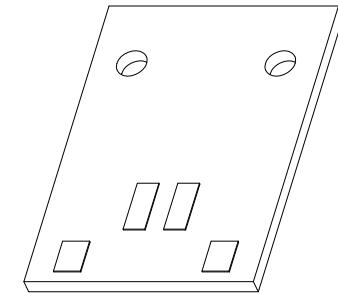

SCALE 2.000

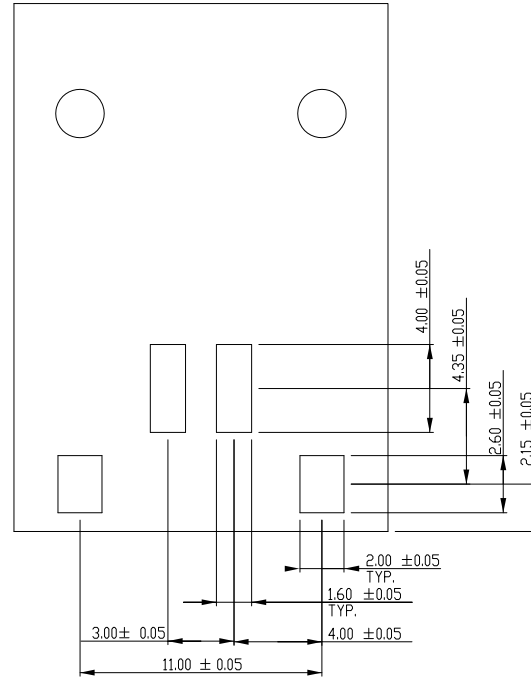

SCALE 3.000



Copyright FCI.

www.fciconnect.com			surface ISO 1302	tolerance std ISO 406 ISO 1101	projection MM		
			TOLERANCES UNLESS OTHERWISE SPECIFIED				
Dr	M JACOB	2013-06-10	ANGULAR	0.X	±X	size	A4
Eng	M JACOB	2013-06-10	LINEAR	0.XX	±0.2	Scale	3.000
Chr	M JACOB	2013-06-10	0° ±2°	0.XXX	±X	ECN	-
Appr	BIJU K PAUL	2013-06-10	Product family-RotaConnect			Spec ref	-
					title		Rev.
			ASSEMBLY, 2 POS HDR TYPE		no		A
			ROTATABLE BOARD TO BOARD CONNECTOR		no		
			catalog no : 10120045-200LF		10120045-200C		
			CUSTOMER DRAWING		sheet 2 of 3		

rev	ecn no	dr	date
-	-	-	-
-	-	-	-
-	-	-	-
-	-	-	-
-	-	-	-
-	-	-	-
-	-	-	-

PART NUMBER
10120045-200LF

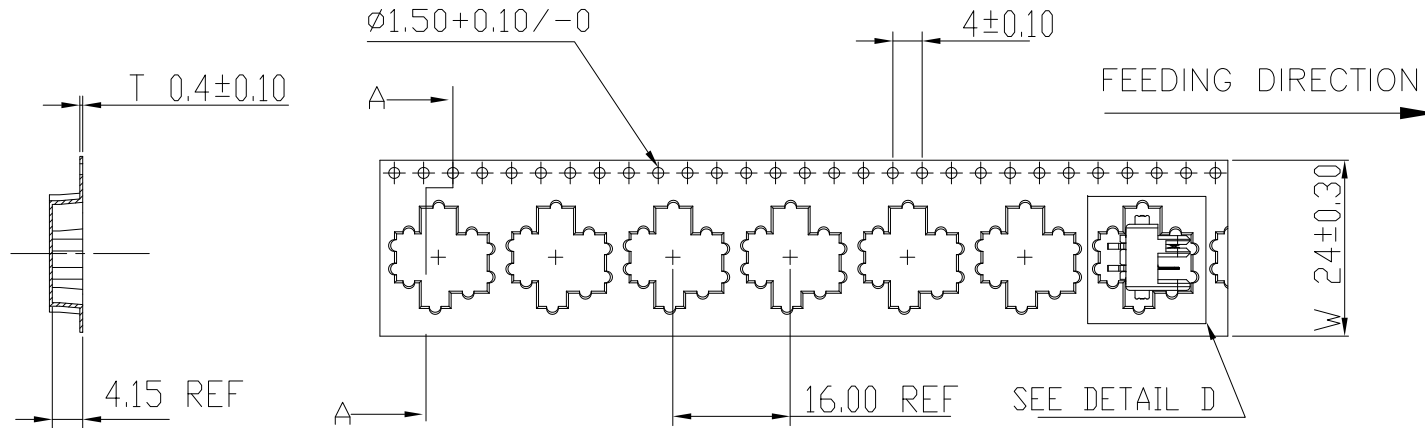

SECTION A-A

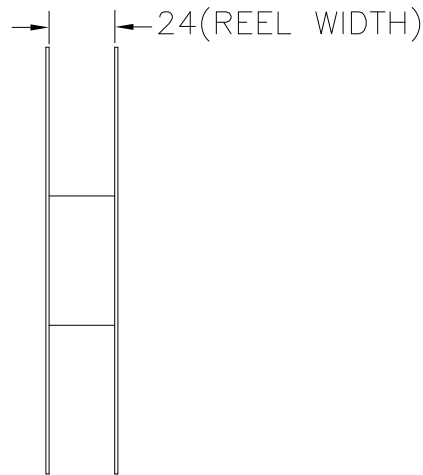
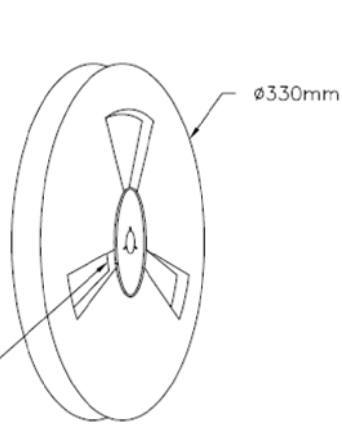

Component inside carrier tape

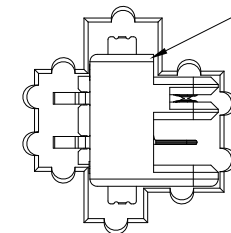

DETAIL D
SCALE 2:1

NOTES :

1. MATERIAL : ANTI-STATIC POLYSTYRENE
2. PACKAGING AS PER EIA-481 STD.
3. QTY PER REEL : 975 NOS

rev	ecn no	dr	date
-	-	-	-
-	-	-	-
-	-	-	-
-	-	-	-
-	-	-	-

www.fciconnect.com			surface ISO 1302	tolerance std ISO 406 ISO 1101	projection MM
Dr	M JACOB	2013-06-10	ANGULAR	0.X ±X	size A4
Eng	M JACOB	2013-06-10	LINEAR	0.XX ±0.2	Scale 1.000
Chr	M JACOB	2013-06-10	0° ±2°	0.XXX ±X	ECN -
Appr	BIJU K PAUL	2013-06-10	Product family	Spec ref	-
			title ASSEMBLY, 2 POS HDR TYPE ROTATABLE BOARD TO BOARD CONNECTOR catalog no : 10120045-200LF		drawing no 10120045-200C Rev. A
CUSTOMER DRAWING					sheet 3 of 3