



The product is approved by Microsoft Window 7

Windows 7

EMTS External Multi Touch Screen for 10.1" NB

Product Features

- No system upgrade needed, gives you incredible touch panel performance using you low cost notebook computer
- Replaces mouse control system, can be used as a handwriting or drawing tablet.
- Easy to carry, assemble and disassemble, lightweight and durable, high transmissiveness, high sensitivity.
- Plug and play with USB device, can be installed on many different models of notebook computers that have the same dimensions.

Product comparison

	EMTS	Conventional
Multi Touch	√	X
Transmissiveness	√	X
Lifespan	√	X
Sensitivity	√	X
Durability	√	X
Precision	√	X

Product Specifications

- Material: Glass
- Dimension: 10.1 inch (247.5mm x 160.5mm x 5.4mm)
- Viewing area: 223.1mm x 125.7mm
- Model number: MCo160
- Weight: 180 g
- Voltage: USB DC5V
- Transmissiveness: Greater than 90%
- Surface hardness: Greater than 6H
- Operation time lifespan: 200 million times
- Operation temperature: -20°C~ 65°C/20%~90%RH
- Storage conditions: -30°C~ 80°C/10%~90%RH
- Operating system:
Win ME/XP/NT/2000/Vista, Windows 7, Linux, Android.

Product Contents

- Touch panel (includes ultra-stylish rubber jelly strap holder)
- USB cable
- Storage bag

Product Applications

- User can write or draw directly the screen. For example, can be used with Microsoft Windows Paint and other drawing and writing tablet software.
- Can be used with games, child educational software and programs that don't work well with a mouse interface. Directly pressing on screen icons with your fingers makes games more fun and computer interaction and learning more interesting to children.
- Other applications include mouse simulation applications and store management. When combined with an inventory management system, it can save you operation time and improve work efficiency.

Compatible with the Following Manufacturers and Models:

ACER Aspire one / ASUS EeePC / DELL Mini10 / Fujitsu M2010 / GIGABYTE M1022 / Q1088 / HP Mini / Lenovo IdeaPad / MSI Wind / Toshiba Mininote

Precautions

- This product is made of glass. Don't drop or tap / scratch with any type of sharp objects.
- This product is very sensitive so it can be operated by a light touch of a finger tip.
- Do not use with wet gloves or fingers to prevent malfunction.
- Do not wipe surface with any organic solvent. Clean with a wiper damp with water.
- Multi touch function is supported only under Window 7 driver. Strongly suggest download the latest driver from operation system suppliers always.



Product Overview



Product Front View after assembly



Slide left / Slide right



Zoom in



Zoom out



Paint



Rotate



Product Back View after assembly

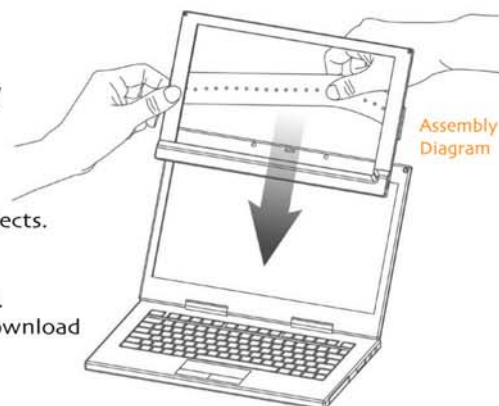

Assembly Diagram

